

**NOTES:**

1. IF ORIGINAL CORE CANNOT BE USED, THEN 12" DIAMETER CORE MUST BE CUT AND THEN FILLED WITH HOT MIX ASPHALT.
2. FLOWFILL MUST BE BATCHED. SUBMIT ALL BATCH TICKETS FOR APPROVAL TO OGDEN CITY ENGINEERING.

**OGDEN CITY ENGINEERING - STANDARD DRAWINGS**



**UTILITY POTHOLING**

**TAYLOR NIELSEN, CITY ENGINEER**

**RD-8**

**SHEET 1 OF 2 | 2025**

### STANDARD POTHOLES (6")

6" POTHOLES PER  
RD-8 SHT 1

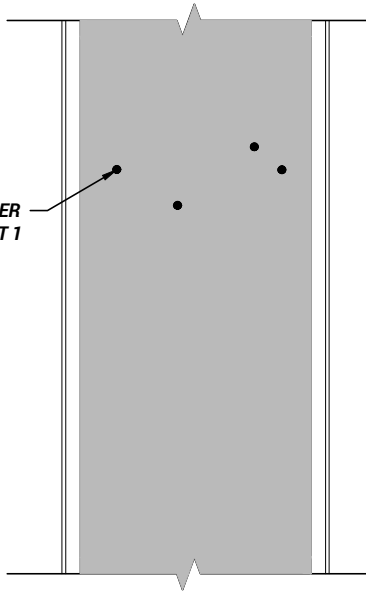

### LARGER POTHOLES (8" +)

SINGLE

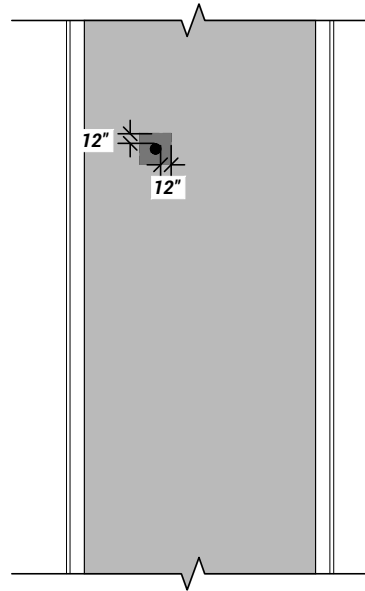

SINGLE UTILITY POTHOLES LARGER THAN 6" CAN BE FILLED PER RD-8 SHEET 1. PATCH MUST BE MINIMUM 12" OVERCUT WITH ALL EDGES CRACK-SEALED. AVOID PLACING EDGE OF PATCH IN WHEEL PATH, EXPAND PATCH SIZE IF NECESSARY.

### LARGER POTHOLES (8" +)

MULTIPLE - SAME SIDE OF ROAD

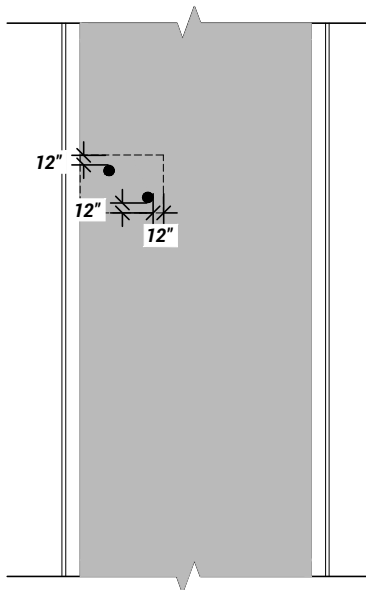

MULTIPLE UTILITY POTHOLES, WHICH ARE LOCATED ON THE SAME SIDE OF THE ROAD AND ARE LARGER THAN 6" CAN BE FILLED ACCORDING TO RD-8 SHEET 1. THE POTHOLES MUST BE COVERED BY A SINGLE ASPHALT PATCH, WHICH TOUCHES THE CLOSEST CURB/GUTTER AND HAS A 12" OVERCUT MEASURED FROM THE THREE OUTERMOST EDGES. ALL EDGES OF THE PATCH MUST BE CRACK-SEALED. AVOID PLACING EDGE OF PATCH IN WHEEL PATH, EXPAND PATCH SIZE IF NECESSARY.

### LARGER POTHOLES (8" +)

MULTIPLE - BOTH SIDES OF ROAD

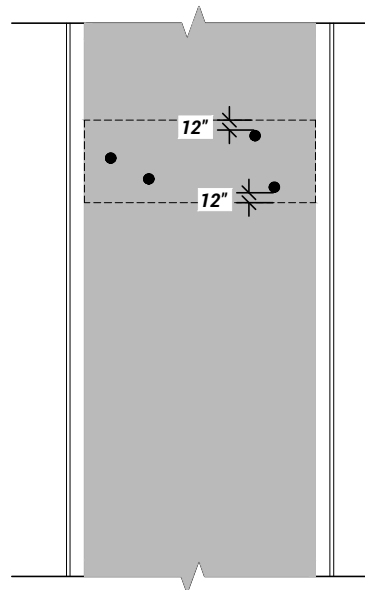

MULTIPLE UTILITY POTHOLES, WHICH ARE LOCATED ON THE SAME SIDE OF THE ROAD AND ARE LARGER THAN 6" CAN BE FILLED ACCORDING TO RD-8 SHEET 1. THE POTHOLES MUST BE COVERED BY A SINGLE ASPHALT PATCH, WHICH EXTENDS THE FULL WIDTH OF THE ROADWAY (LIP TO LIP) AND HAS A 12" OVERCUT MEASURED FROM THE OUTERMOST EDGES. ALL SAWCUT EDGES OF PATCH MUST BE CRACK-SEALED.

## OGDEN CITY ENGINEERING - STANDARD DRAWINGS



### UTILITY POTHOLING

TAYLOR NIELSEN, CITY ENGINEER

**RD-8**

SHEET 2 OF 2 | 2025